

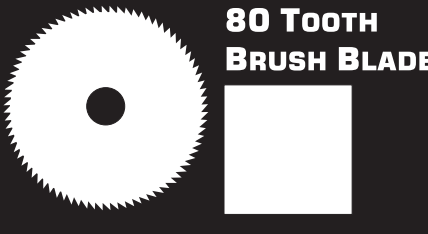

# BRUSH CUTTER BLADE

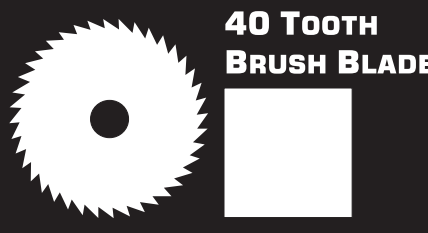

### CAUTION! READ BEFORE USING!

This cutting blade is designed exclusively for brush cutters. Do not use it in any other applications.

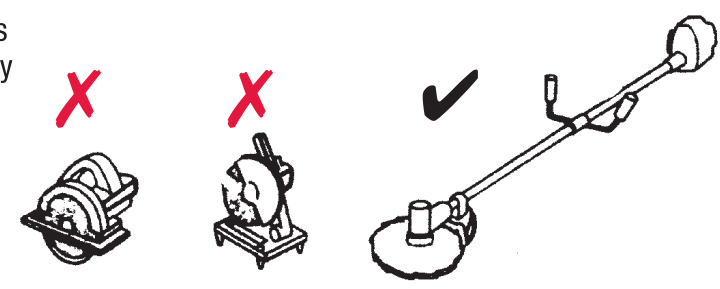

**NOTE:** 3, 4, and 8-Tooth blades are for cutting non-woody vegetation only!

Mount the blade correctly on the brush cutter. The label side goes on top. Make sure the blade bore matches the arbor size.

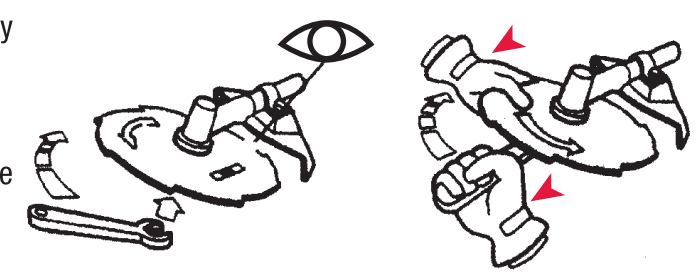

Consult your owner's manual for installation instructions.

Check the blade before beginning work. Never use any blade that is cracked, bent or otherwise damaged. Always use with the correct blade guard mounted.

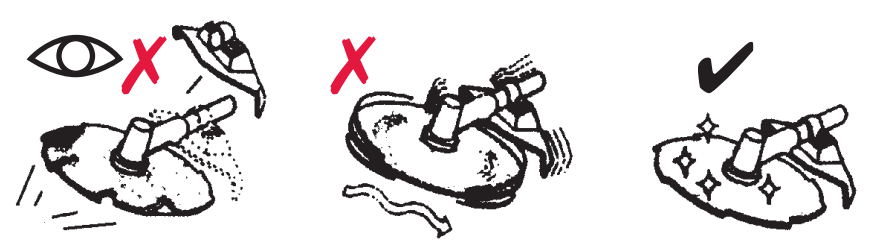

Always wear protective gear for working safety.



- Don't forget your:
- Safety Glasses
  - Hearing Protection
  - Helmet
  - Safety Boots
  - Gloves

While working, always check that no one else or no obstacle is present within a 50-foot radius.

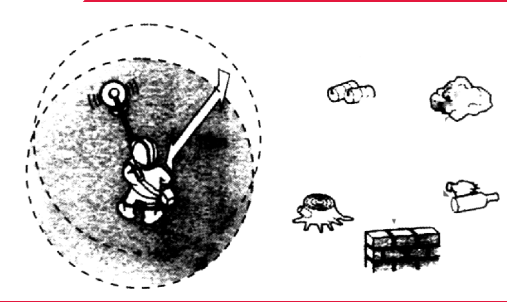

- AVOID:**
- Cans
  - Bottles
  - Stumps
  - Stone
  - Foundations

Inspect the blade for damage after striking a foreign object.



- SAW CHAIN
- GUIDE BARS
- SPROCKETS
- FILES
- TRIMMER AND BRUSHCUTTER ACCESSORIES

IMPORTED BY  
**TILTON**  
 EQUIPMENT COMPANY  
[WWW.TILTONEQUIPMENT.COM](http://WWW.TILTONEQUIPMENT.COM)

MADE IN CHINA